

MC RW

MC RW ROOF WINDOW

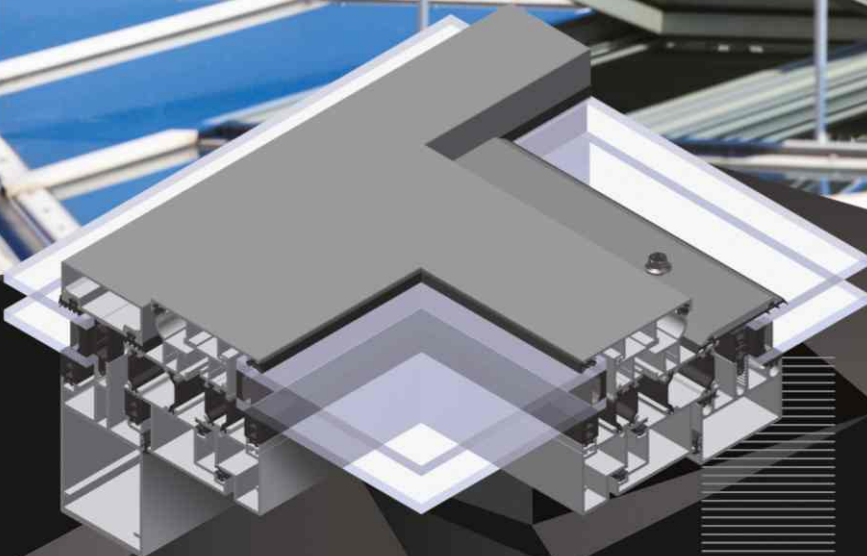
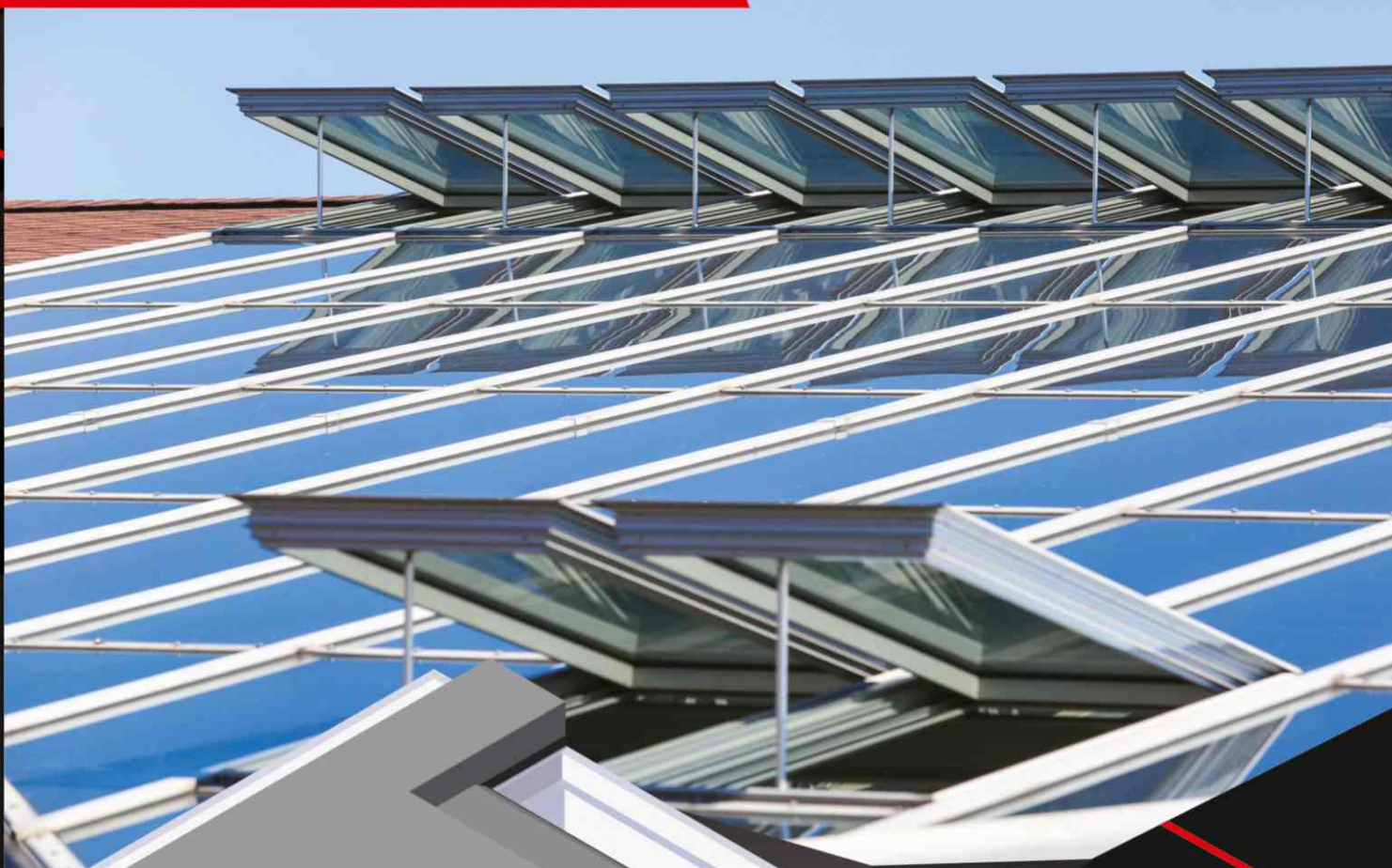

Three-chamber system with thermal insulation, used to design roof windows. The MC RW roof window is a solution based on the MC Wall facade system. This type of structures is used to design ventilation dampers. Windows and smoke ventilators have a specific role in ensuring safety and comfort of the building residents.

# MC RW

The MC RW roof window is a solution based on the MC Wall facade system. This type of structures is used to design ventilation flaps.

The MC RW is a three-chamber system with thermal insulation. It is optional to use an additional insulating components to improve thermal aspects of the structure (under-glass inserts, inserts between thermal separators).

The structure can be installed on roofs with the pitch ranging from 5° to 75° relative to the horizontal.

The MC RW roof window is fitted with an effective drainage and ventilation system integrated with the mullion-transom wall system.

Maximum structure dimensions:

- 2120 x 1120 mm – maximum total pane area: 1,9 m<sup>2</sup>  
(for this overall dimensions it is possible to use 6 ESG/16/442 glass)
- 1970 x 2070 mm – maximum total pane area: 3,48 m<sup>2</sup>

The window weight is limited by technical parameters of the applied opening mechanisms and hinges. The weight can be up to 150 kg.

The MC RW structure can be used with a wider range of closers available on the market. The MC RW roof window can be fitted with a manual or electrical opening mechanism.

Optional to use glazing units with the thickness from 28 to 46 mm.

Wide range of colours – RAL palette (Qualicoat 1518), texture colours, Aliplast Wood Colour Effect (wood-like colours), Aliplast Loft View – colours imitating stone surfaces (Qualideco PL-0001), anodized colour (Qualanod 1808), bi-colour.

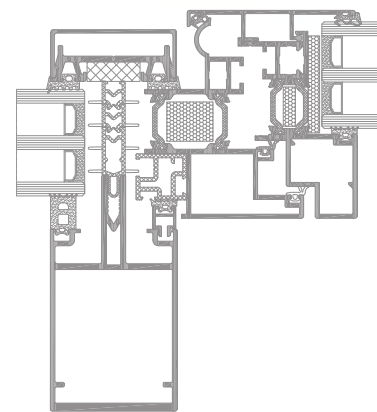

MC RW cross section (leaf and transom connections)

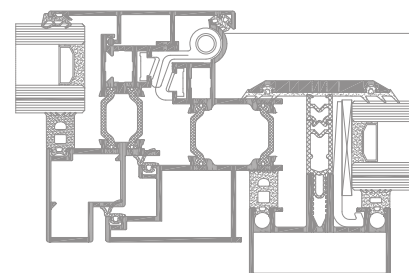

MC RW cross section (hinge side)

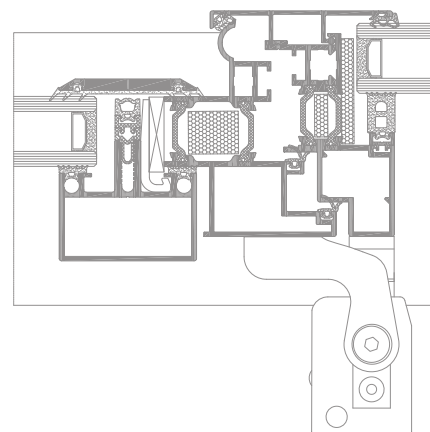

MC RW cross section (leaf and transom connections)

## TECHNICAL SPECIFICATION

SYSTEM	DEPTH OF FRAME	DEPTH OF LEAF	GLAZING RANGE	MAXIMUM SIZES	TYPE OF WINDOW	TYPE OF GLAZING
MC RW	87 mm	81 mm	28-46 mm	2000 x 2100 mm	roof window	glazing strip

## PERFORMANCE

SYSTEM	THERMAL INSULATION Uf *	AIR PERMEABILITY	WINDLOAD RESISTANCE	WATERTIGHTNESS
MC RW	Uf from 1,70 W/m <sup>2</sup> K	Class 4; EN 12207	CE/BE 2400; EN 12210	Class E2100; EN 12208

\* Thermal insulation is dependent on a combination of profiles and thickness of the filling.