

VS600

VERTICAL SLIDING WINDOW



The VS600 vertical sliding window is a brand new innovation to Aliplast product range. VS600 incorporates the traditional styling of sash windows with the advantages of modern thermal aluminium profile.

VS600

System featuring increased thermal insulation, for designing vertical sliding structures.

System equipped with a profile-concealed drive supplied by a reputable company, for the sashes to be moved vertically (the drive also provides the tilting function to make it easier to clean the outside of the glazing).

Available infill thicknesses: 24 mm and 28 mm.

Frame depth: 126 mm.

System used in the design of residential and public buildings (schools, hospitals, banks) as well as in renovation projects; it can be used as a pass-through window in offices, canteens, receptions, banks.

The VS600 vertical sliding window is a brand new innovation to Aliplast product range. VS600 incorporates the traditional styling of sash windows with the advantages of modern thermal aluminium profile.

Wide range of colours – RAL palette (Qualicoat 1518), texture colours, Aliplast Wood Colour Effect (wood-like colours), Aliplast Loft View – colours imitating stone surfaces (Qualideco PL-0001), anodized colour (Qualanod 1808), bi-colour.

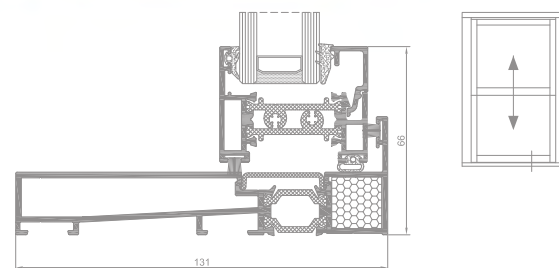

internal sash with horizontal bottom frame

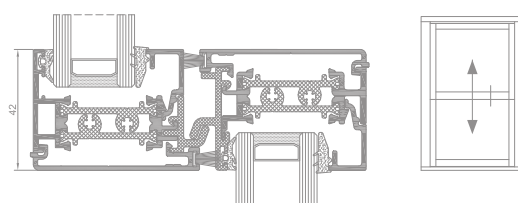

VS600 section through the connection sash-sash

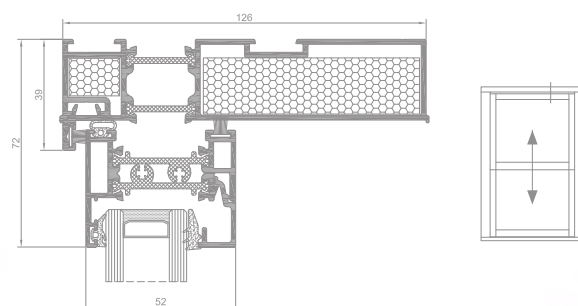

external sash with horizontal top frame

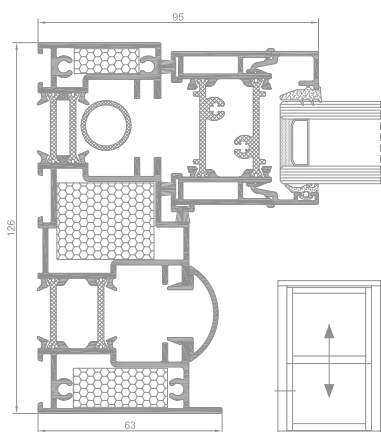

internal sash with vertical frame

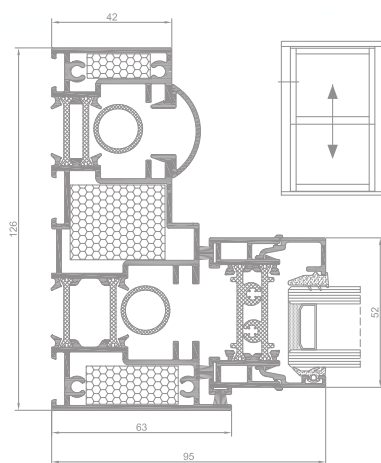

external sash with vertical frame

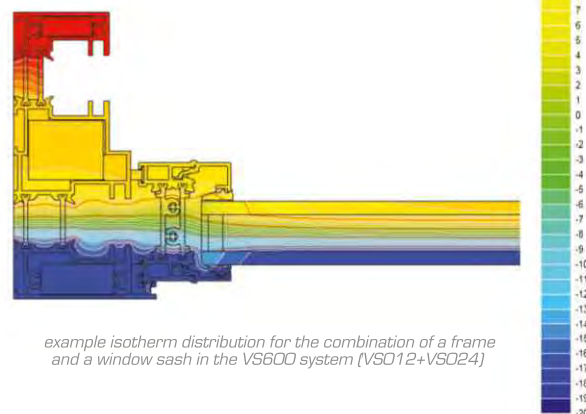

example isotherm distribution for the combination of a frame and a window sash in the VS600 system (VSO12+VSO24)

TECHNICAL SPECIFICATION

SYSTEM	MATERIAL	MAX WIDTH	MAX HEIGHT	MAX WEIGHT	GLAZING RANGE	MAXIMUM WINDOW SIZES
VS600	aluminium / polyamid	1600 mm	2490 mm	31 kg (leaf)	24 mm, 28 mm	970 x 1490 mm

PERFORMANCE

SYSTEM	THERMAL INSULATION U_f *	AIR PERMEABILITY	WINDLOAD RESISTANCE	WATERTIGHTNESS
VS600	U_f from 1,60 W/m ² K	Class 3; EN 12207	Class A4; EN 12210	Class 7A (300 Pa)

* Thermal insulation is dependent on a combination of profiles and thickness of the filling.